



Unit Type B2 – One Bedroom with Triangle Bay Windows, Large Study & Powder Room

965 Square Feet

Apartment Features

- Hudson River and Palisades Views
- High 9' 5" Ceilings
- Open Kitchen with Euro-style Cabinetry & Stainless Steel Appliances
- Designer Master Bathroom with Contemporary Vanity
- Separate Powder Room
- Extra Large Study/Home Office, suitable for Guest Room
- Large Walk-in Closet, Double-Sized Coat Closet and Linen Closet
- Laminate Wide-plank Wood Flooring throughout
- Full Size Washer & Dryer in Unit

Building & Community Features

- Spectacular Location overlooking The Hudson River & The Palisades
- Elegant Lobby & Club Lounge
- Sunset Deck Overlooking the Hudson River
- In-Building Fitness Center
- Full Access to River Tides Pool, Spa, Fitness Classes & Building Events
- App Based Security System with Secure Automated Package Delivery
- Indoor Garage Parking
- On Site Property Management
- Access to Walkway to Greystone Metro-North Station
- Smoke Free & Pet Friendly



Come home to vacation.
Resort-style luxury residences from GDC.

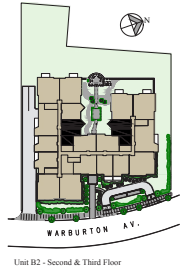

** All dimensions, square footage, layouts, window sizes and location are approximate and subject to change based upon construction and site variables. Before ordering furniture and decor items, it is recommended that all tenants personally measure their unit to confirm all dimensions.*

DWELLING UNITS INCLUDE FEATURES FOR PERSONS WITH DISABILITIES REQUIRED BY THE FHA.

On-site Leasing Center:

1177 Warburton Avenue
Yonkers, NY 10701

1-914-963-1220
email: 1177@gdcrentals.com
www.gdcrentals.com

Date: _____

Apartment Number: _____

Rent: _____

Notes: _____
